

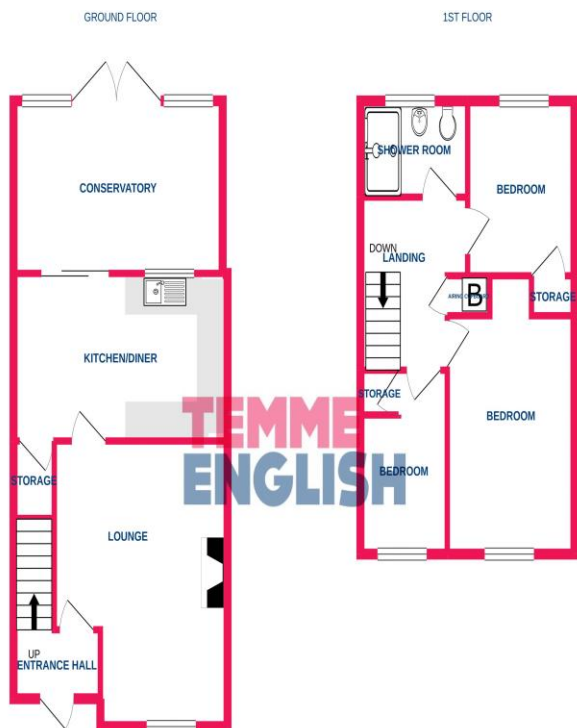

Located on the Hyde Way estate, ideal for those who commute and looking for easy access to the High Street and schools is this spacious and much improved THREE- Bedroom home. The property benefits from brand new carpets and a brand new Shower Room/WC. The accommodation commences with an inviting porch leading into a roomy living room. This in turn, leads to a Kitchen/Diner (which has double doors leading out to a huge conservatory, ideal for an additional reception room. Upstairs plays host to an ultra modern shower rooms and well-proportioned bedrooms. Every room has built-in wardrobes, with bedroom one benefitting from a range of bespoke fitted wardrobes. There is a neat rear garden and a garage wider than the average on this popular estate. Walkway location - Available Now! Call now to arrange a viewing 01268 573035.

Price Monthly Rental Of £1,400



While every attempt has been made to ensure the accuracy of the floorplan contained here, measurements of floors, windows, doors and any other items are approximate and are not intended to be used for any legal, construction or other purposes. This plan is for illustrative purposes only and should not be used as a substitute for any professional advice. The actual appearance and dimensions of the property may vary from those shown on this floor plan. Please contact the agent for more information.

- Entrance Hall
- Lounge (15'6 x 12'5)
- Kitchen/Diner (9'2 x 15'8)
- Huge Conservatory
- Ultra-Modern Bathroom
- Bedroom 1 (12'7 x 8'9)
- Bedroom 2 (9'6 x 7'6)
- Bedroom 3 (9'0 x 6'7)
- Oversized Garage
- Available Now!

