

TEMME  
ENGLISH



## Riverview, London Road, £200,000

We are delighted to offer this extremely well presented ONE-bedroom THIRD FLOOR apartment located almost opposite the High Street and therefore just a short stroll to the Railway Station. Internally the property has been much improved by the current owners. The vast accommodation includes an inviting 'L' shaped entrance hall with a double storage cupboard and a single, impressive bathroom suite and double main bedroom. The property has a fantastic kitchen with plenty of integrated appliances & lots of worktop space. The living room includes French inward opening doors to the Juliette balcony. Positioned on the third floor all windows and the Juliette balcony benefit from far reaching views across Wickford town centre. There is lift access to all levels and allocated parking. Viewing is highly advised. call now too arrange your viewing .

TEMME  
ENGLISH



## Ground Floor

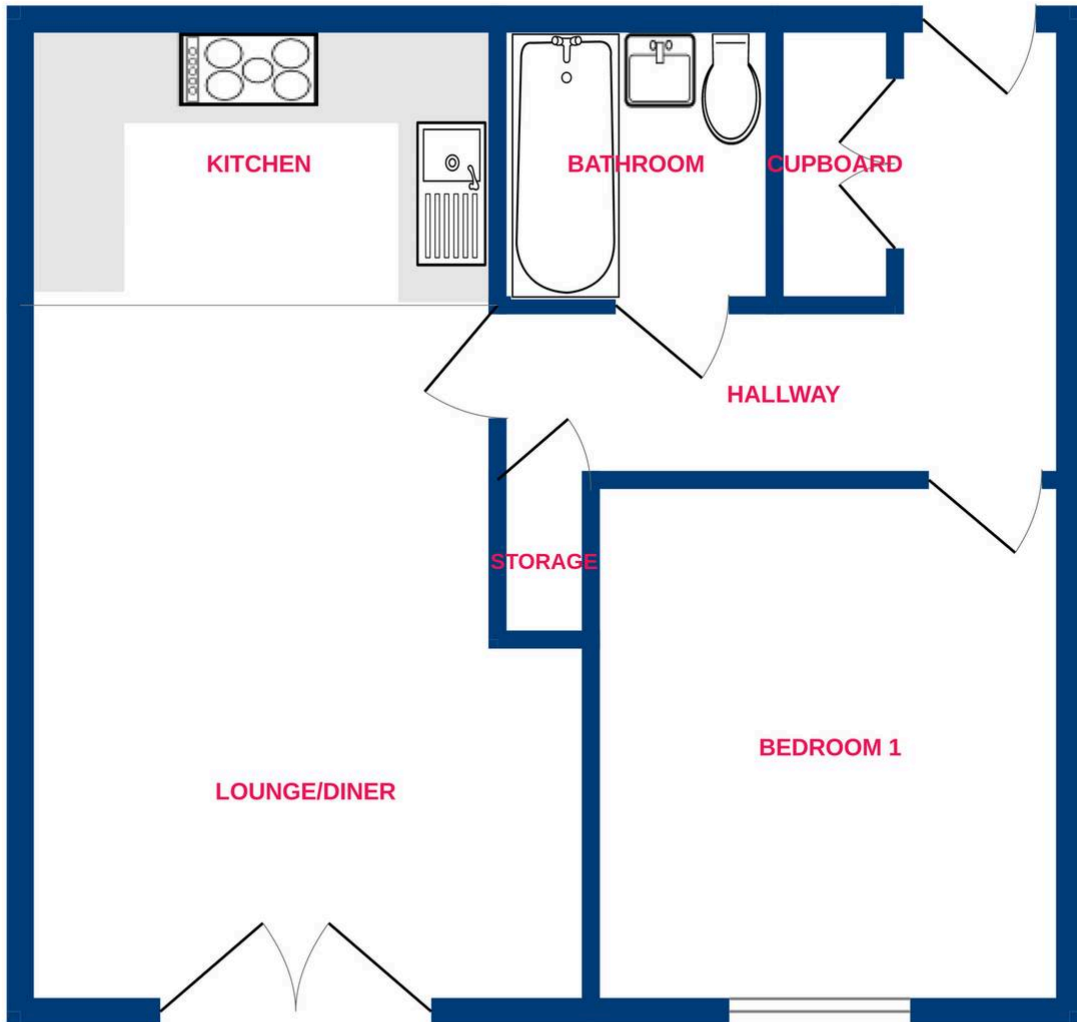

Whilst every attempt has been made to ensure the accuracy of the floorplan contained here, measurements of doors, windows, rooms and any other items are approximate and no responsibility is taken for any error, omission or mis-statement. This plan is for illustrative purposes only and should be used as such by any prospective purchaser. The services, systems and appliances shown have not been tested and no guarantee as to their operability or efficiency can be given.  
Made with Metropix ©2026

You can include any text here. The text can be modified upon generating your brochure.