



The Forge, Woodlands Road, £215,000

Temme English are thrilled to present this opportunity for the buyer seeking a TWO Bedroom apartment in a town centre location. Located on the second level this apartment style home has it all. Space, style and luxurious fittings. Commencing with an entrance hall leading to both bedrooms, living area and a modern bathroom with shower over bath. Both the bedrooms are of a double size with the main both allowing plenty of natural light. The bright and airy living area is stylish with a fantastic kitchen area comprising granite work tops and ample units. The Forge is perfectly place for Wickford Railway Station and is a stone's throw from the Town Centre. Viewing comes highly recommended so the true size and style on offer, call today to arrange your viewing.



**TEMME
ENGLISH**



Ground Floor

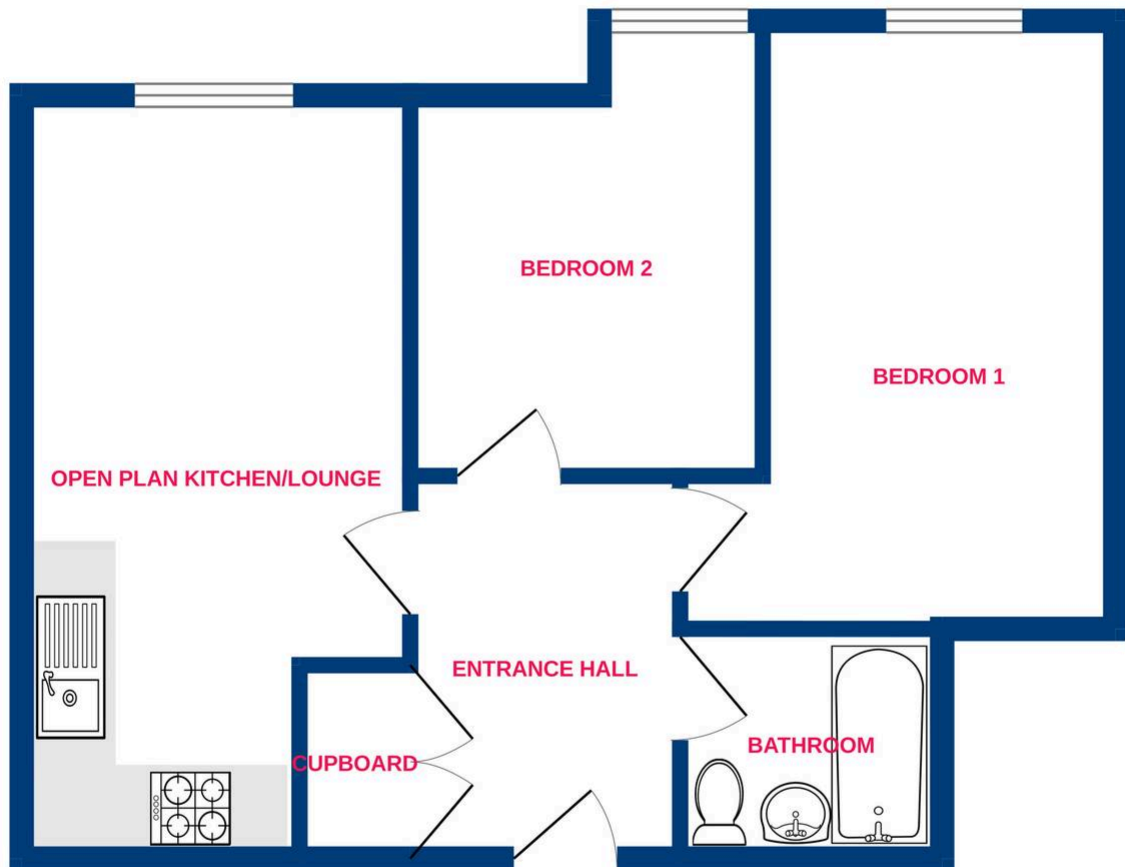

Whilst every attempt has been made to ensure the accuracy of the floorplan contained here, measurements of doors, windows, rooms and any other items are approximate and no responsibility is taken for any error, omission or mis-statement. This plan is for illustrative purposes only and should be used as such by any prospective purchaser. The services, systems and appliances shown have not been tested and no guarantee as to their operability or efficiency can be given.
Made with Metropix ©2026

You can include any text here. The text can be modified upon generating your brochure.