



Laburnum Avenue, £400,000

Temme English are pleased to market this well presented and extended "keyhole style" TWO double bedroom semi-detached bungalow situated in a quiet and sought after road within walking distance to Wickford town centre and mainline rail station. Internally this beautiful home offers the new owner great sized bedrooms, family bathroom, spacious lounge/diner and impressive well sized modern gally style kitchen with ample work surface area and doors opening onto the garden allowing for lots of natural light. Externally the south facing rear garden profits from multiple outbuildings for storage. To the front this property has fantastic kerb appeal and a large driveway for multiple vehicles. The current owner has made many improvements over the years and this home would be perfect for those wanting a stress and fuss free move. Viewings come highly recommended to fully appreciate what is on offer. NO ONWARD CHAIN!



**TEMME
ENGLISH**



Ground Floor

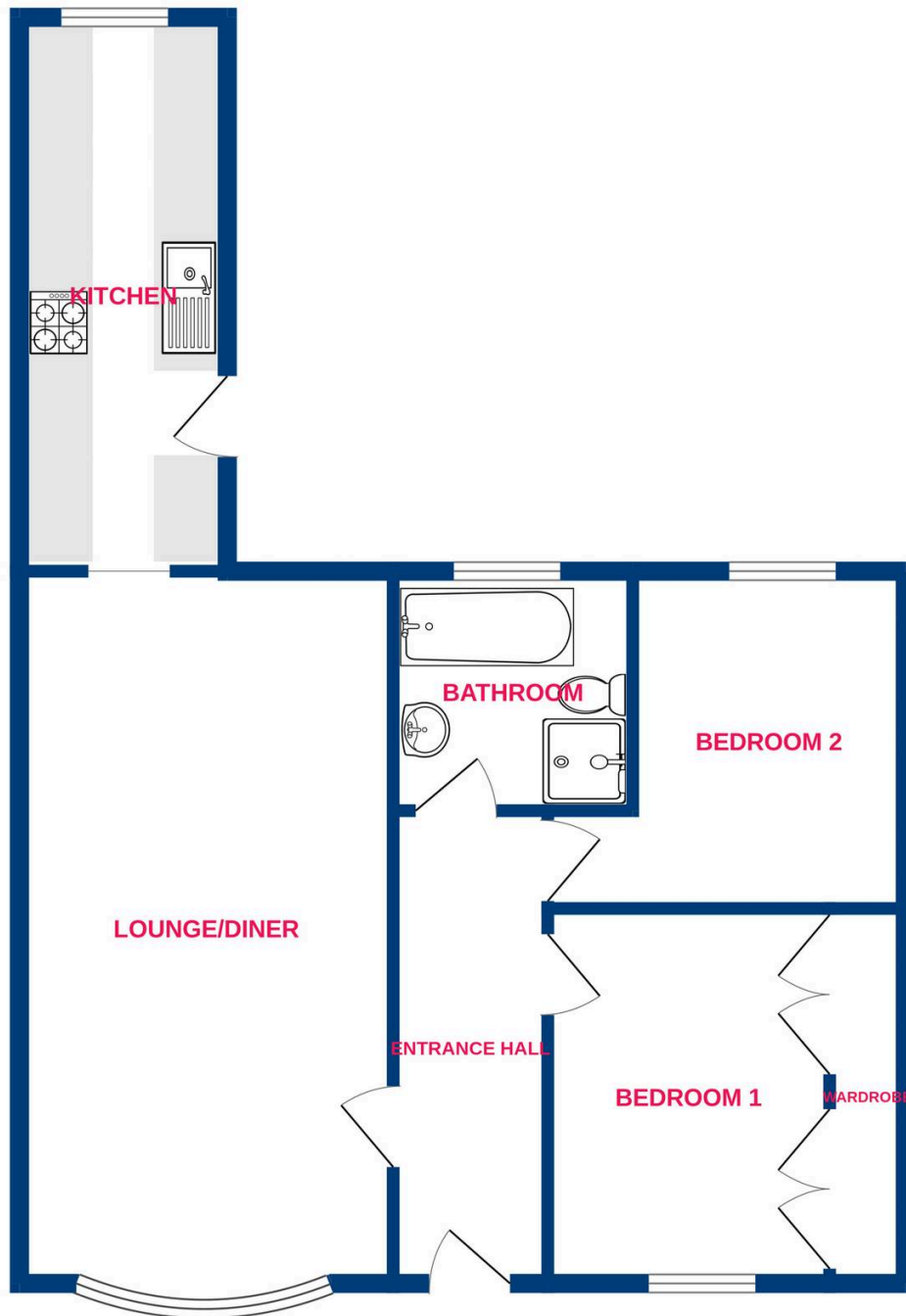

Whilst every attempt has been made to ensure the accuracy of the floorplan contained here, measurements of doors, windows, rooms and any other items are approximate and no responsibility is taken for any error, omission or mis-statement. This plan is for illustrative purposes only and should be used as such by any prospective purchaser. The services, systems and appliances shown have not been tested and no guarantee as to their operability or efficiency can be given.
Made with Metropix ©2026

You can include any text here. The text can be modified upon generating your brochure.