



## Leasway, Guide Price £300,000 – £325,000

GUIDE PRICE £300,000 – £325,000. NO ONWARD CHAIN!  
Positioned on a highly desirable road off of London Road is this extended TWO bedroom semi-detached bungalow. The property is situated within walking distance to Wickford High Street and railway station giving direct access into London Liverpool Street. Internally the property boasts TWO good sized bedrooms, a 13'9 long living room, kitchen and bathroom. As mentioned the property has been extended in the past to house a dining room overlooking the rear garden. Externally the property has a west facing rear garden with side access as well as parking for two vehicles and potential for further with a paved driveway to the front. The home does need modernisation but has been kept very clean and liveable. Call us now to arrange an appointment on!



**TEMME  
ENGLISH**



Ground Floor

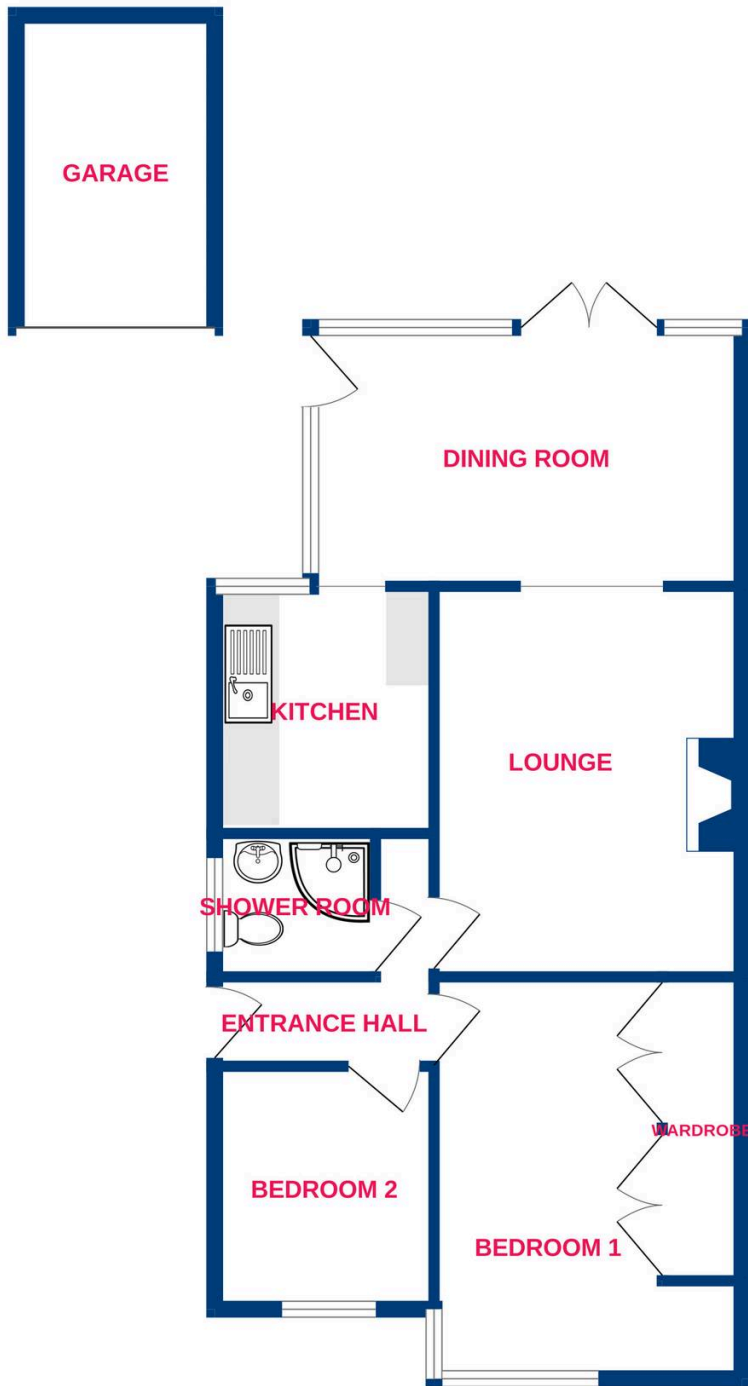

Whilst every attempt has been made to ensure the accuracy of the floorplan contained here, measurements of doors, windows, rooms and any other items are approximate and no responsibility is taken for any error, omission or mis-statement. This plan is for illustrative purposes only and should be used as such by any prospective purchaser. The services, systems and appliances shown have not been tested and no guarantee as to their operability or efficiency can be given.  
Made with Metropix ©2026

You can include any text here. The text can be modified upon generating your brochure.