

TEMME
ENGLISH



Radwinter Avenue, £400,000

Located close in Radwinter Avenue is this deceptively spacious THREE bedroom family home. With the versatile accommodation spread over three floors the ground floor offers a W/C, kitchen come breakfast room and a lounge/Diner overlooking the rear garden. The first floor plays host bedrooms TWO & THREE with two having a walk-in wardrobe as well as a family bathroom. To the top floor of the property is the main bedroom with fitted wardrobes and further en suite. Externally there is a low maintenance rear garden as well as a garage and off street parking. An internal viewing is the best way to fully appreciate the size and quality on offer with this family home. NO ONWARD CHAIN!



TEMME
ENGLISH



Ground Floor

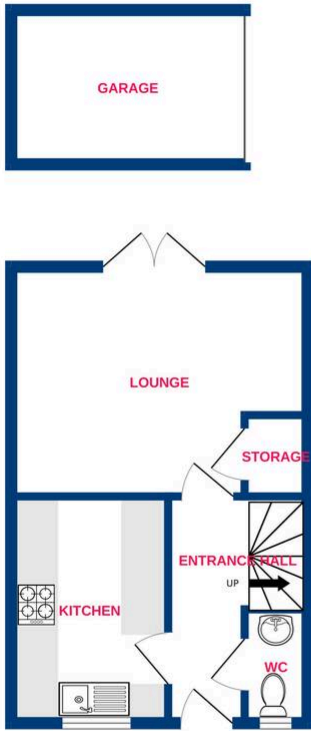

1st Floor

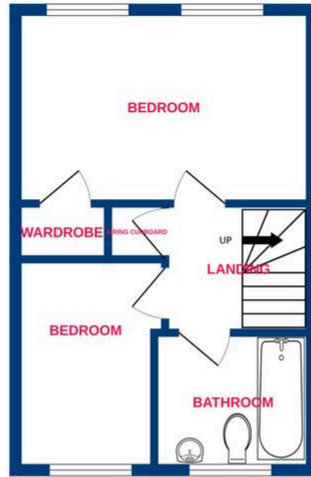

2nd Floor



Whilst every attempt has been made to ensure the accuracy of the floorplan contained here, measurements of doors, windows, rooms and any other items are approximate and no responsibility is taken for any error, omission or mis-statement. This plan is for illustrative purposes only and should be used as such by any prospective purchaser. The services, systems and appliances shown have not been tested and no guarantee as to their operability or efficiency can be given.
Made with Metropix ©2026

You can include any text here. The text can be modified upon generating your brochure.