

TEMME ENGLISH



Rushbrook Avenue, O.I.E.O £350,000

Temme English are proud to market this TWO bedroom starter home located in the sought after development of St Lukes Park. Built back in 2019 the current owners have lived here since new and it is now time for them to move onto their next family home. As you enter the home you are greeted by a wide entrance hall leading to both double bedrooms, family bathroom and added extra en suite to the main bedroom. To complete this luxurious flat you can't help but love this wow factor plenty of storage, & stylish open plan kitchen/diner/lounge area. Social space designed specifically for entertaining in mind. Externally the property comes with TWO undercover allocated parking spaces and 4 years remaining NHBC. Location wise you find yourself in a private pocket of Wickford, bus routes at the end of the road enabling you to get places without the need of taking the car, especially if you work in the London providing you access to the train station in no time at all. Bridal paths leading you to Wickford's town centre, call today to arrange your viewing.

TEMME ENGLISH



Ground Floor

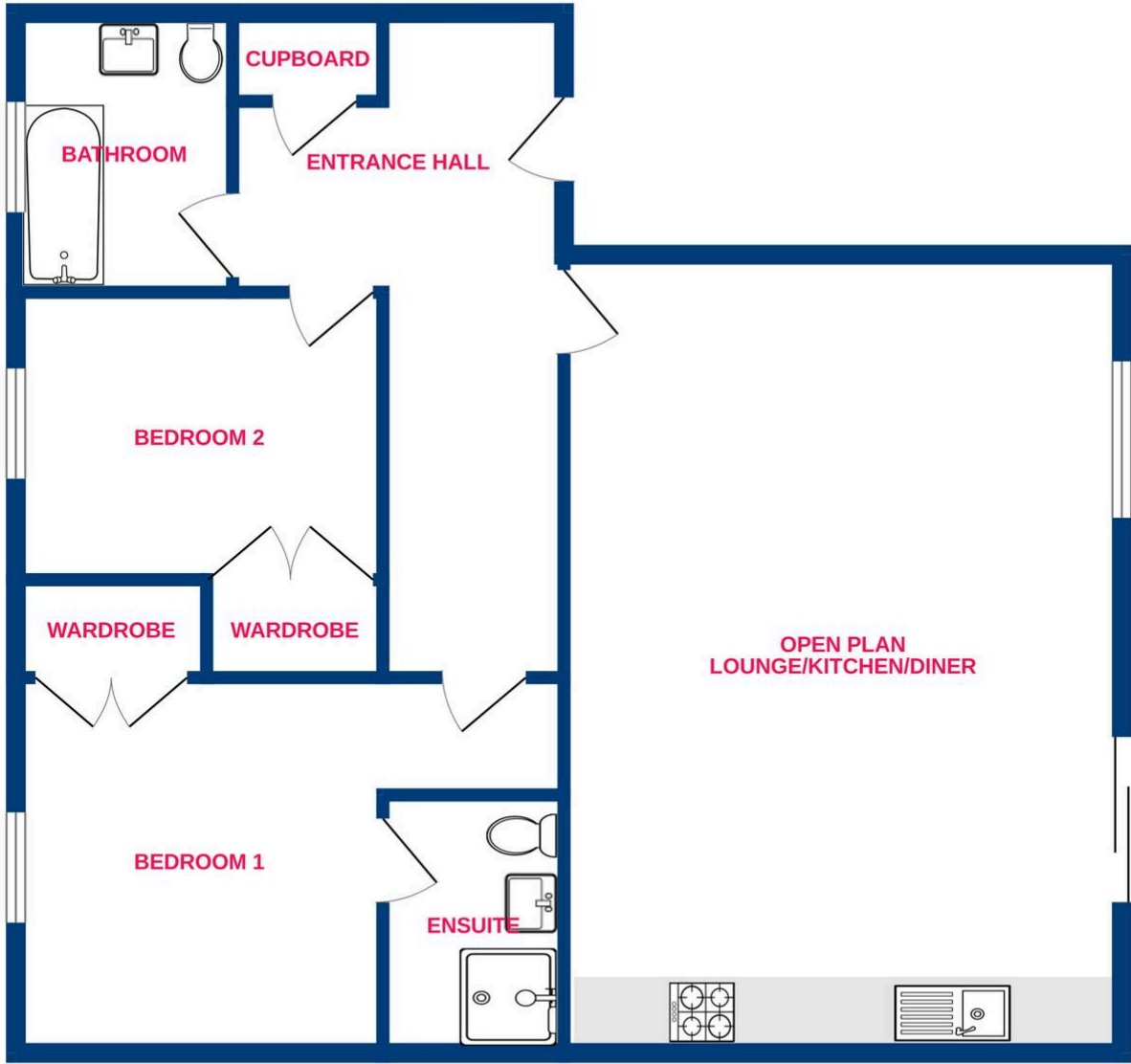

Whilst every attempt has been made to ensure the accuracy of the floorplan contained here, measurements of doors, windows, rooms and any other items are approximate and no responsibility is taken for any error, omission or mis-statement. This plan is for illustrative purposes only and should be used as such by any prospective purchaser. The services, systems and appliances shown have not been tested and no guarantee as to their operability or efficiency can be given.
Made with Metropix ©2026

You can include any text here. The text can be modified upon generating your brochure.