

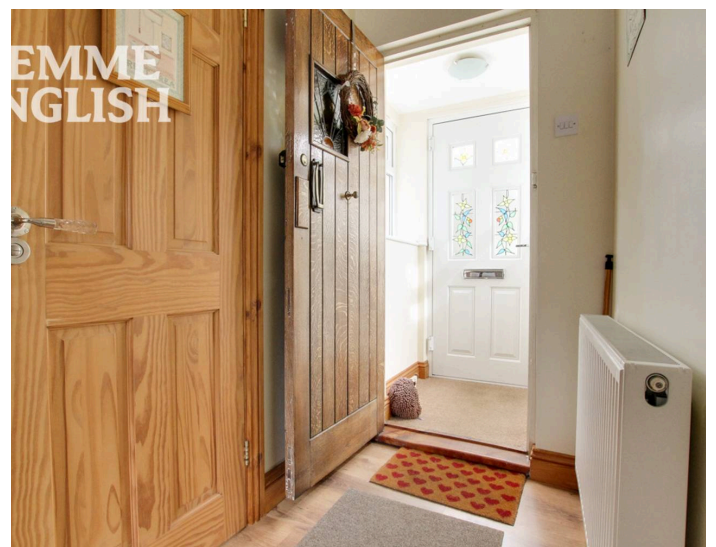

Hawk Lane, Battlesbridge, £600,000

Located within Battlesbridge on a plot measuring 0.55 of an acre is this fantastic bungalow. This most attractive home has such a good feel about it internally. As for the exterior, only by seeing for your own eyes can you believe how large the plot is. Internally the accommodation commences with an entrance porch and a long hallway housing the shower room & lounge. Further on is the Kitchen/Diner which is hugely impressive with an array of units and worktop space. The overall size internally is surprisingly spacious. All of the bedrooms are double sizes with ample natural sunlight flooding in. The bathroom is modern and consists of a tiled shower cubical, WC and wash hand basin. To complete the inside, you have a utility room and ample brick-built fireplaces. The Benson family have resided here for many decades dating back to the early 1800's and took over residence in 2011 and have enjoyed the property ever since! The exterior has so much to offer., the plot begins with a long driveway leading to ample parking and a double garage. The garden wraps around the whole property offering vegetable patches, ponds, secret gardens and an additional hideaway plot. Call us today to view this unique home!



**TEMME
ENGLISH**



Ground Floor

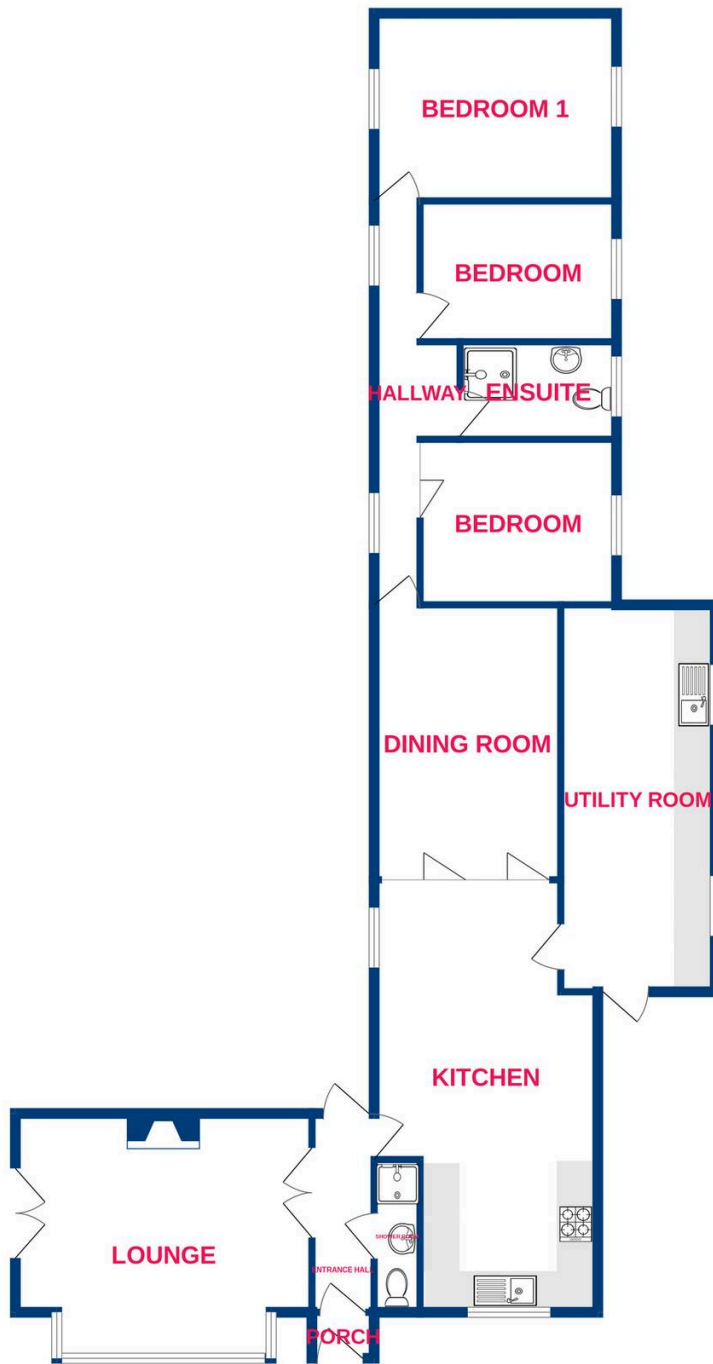

Whilst every attempt has been made to ensure the accuracy of the floorplan contained here, measurements of doors, windows, rooms and any other items are approximate and no responsibility is taken for any error, omission or mis-statement. This plan is for illustrative purposes only and should be used as such by any prospective purchaser. The services, systems and appliances shown have not been tested and no guarantee as to their operability or efficiency can be given.
Made with Metropix ©2026

You can include any text here. The text can be modified upon generating your brochure.