



Riverside Court, £230,000

Located on Lower Southend Road, this block of flats provides an affordable entry into the Wickford property market. With two DOUBLE bedrooms one with fitted wardrobes, modern bathroom and a large open plan Kitchen/Living area the flat is well-suited for those seeking a manageable living space without compromising on essential amenities. The Kitchen has been revamped by the current owners and have added a luxury breakfast bar. Wickford is a well-connected town with a variety of local amenities and transport links. The nearby train station provides easy access to London, making it an excellent option for commuters whilst also having one allocated gated car space. Residents will also appreciate the close proximity to local parks and community facilities. This property is an attractive option for first-time buyers looking to step onto the property ladder or investors seeking a reliable rental opportunity. Its affordable price point ensures it won't remain on the market for long. Don't miss out on this chance to own a part of Wickford's thriving community; contact us today to learn more.



**TEMME
ENGLISH**



Ground Floor

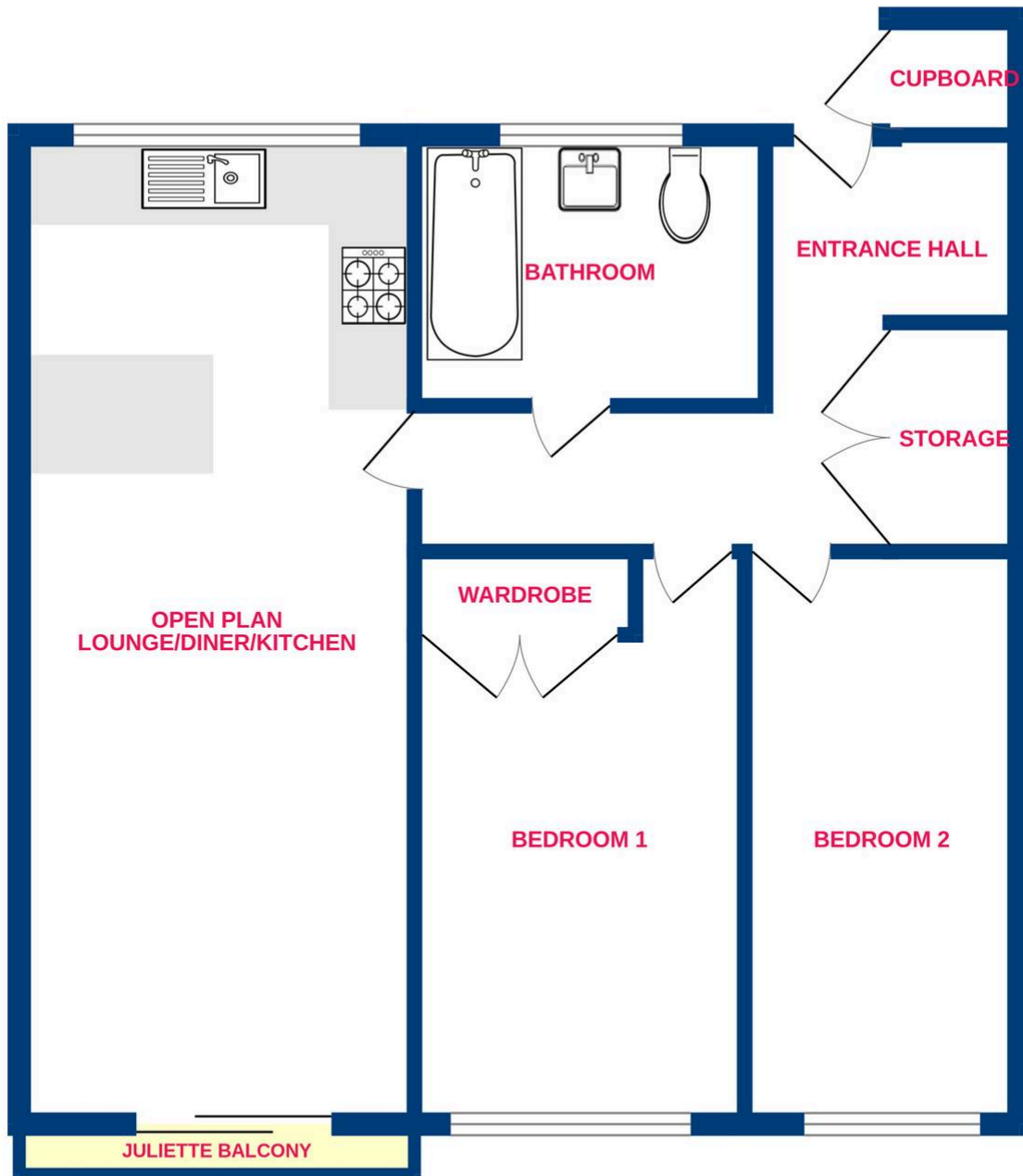

Whilst every attempt has been made to ensure the accuracy of the floorplan contained here, measurements of doors, windows, rooms and any other items are approximate and no responsibility is taken for any error, omission or mis-statement. This plan is for illustrative purposes only and should be used as such by any prospective purchaser. The services, systems and appliances shown have not been tested and no guarantee as to their operability or efficiency can be given.
Made with Metropix ©2026

You can include any text here. The text can be modified upon generating your brochure.