



Melville Drive, £325,000

Positioned within this popular location on the Wick Meadows off of Cranfield Park Road is this lovely looking TWO bedroom house in Melville Drive built by the popular reputable Leftley Brothers. Offering a well-proportioned layout the property benefits from features such as an entrance hall with storage, Kitchen and lounge/diner which overlooks the south facing rear garden. Upstairs hosts TWO bedrooms, family bathroom and further storage. Externally as mentioned the garden is south facing and further unoverlooked with a TWO car driveway to the front. Offered with No onward chain, call us today to arrange your viewing!



**TEMME
ENGLISH**



Ground Floor

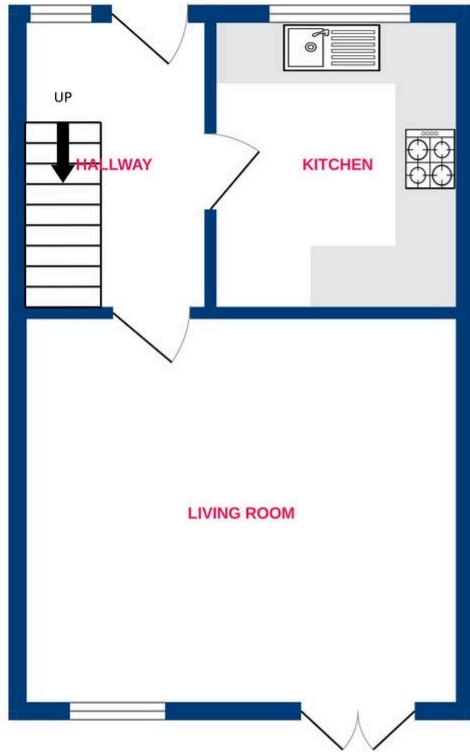

1st Floor

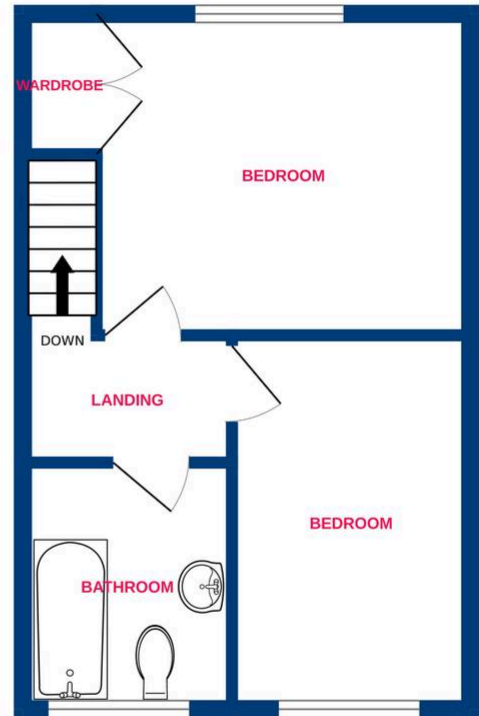

Whilst every attempt has been made to ensure the accuracy of the floorplan contained here, measurements of doors, windows, rooms and any other items are approximate and no responsibility is taken for any error, omission or mis-statement. This plan is for illustrative purposes only and should be used as such by any prospective purchaser. The services, systems and appliances shown have not been tested and no guarantee as to their operability or efficiency can be given.
Made with Metropix ©2026

You can include any text here. The text can be modified upon generating your brochure.